

INSTALLATION INSTRUCTIONS

VOLKSWAGEN NEW JETTA (2005.5-2007)
VOLKSWAGEN GTI (2006-2007)
VOLKSWAGEN RABBIT (2006-2007)



NOTE: READ INSTRUCTIONS COMPLETELY BEFORE INSTALLING THIS BRACKETRON PHONE MOUNT.

All instructions are written from the drivers seat position looking forward at the vehicle dash. We advise caution whenever your removing or handling plastic parts of a vehicles dash. **WARNING:** Unnecessary force or pressure can cause pieces to crack or break.

Logo and part number will be right side up and readable when installed.

TOOLS NEEDED: Dash Trim Tool, (Part #SIT-104), #T-20 Torx driver.

PARTS INCLUDED: One Custom Bezel Mount and Instructions.

LOCATION OF MOUNT: To the Right of the Radio



Step 1.

Begin installation by removing the dash bezel from above the radio. There are two clips that hold this top bezel to the bezel that surrounds the radio. Use the Dash Trim Tool (Part #SIT-104) to separate these two dash bezels. Separate this top bezel by releasing the clips that secure it to the dash. Pry this dash bezel upwards to gain access to the screws that lie beneath the bezel.

Step 2.

When the bezel is loose, pry it gently upward and remove the two (2) #T-20 Torx screws from the top of the bezel that surrounds the radio. Set these two screws aside. Release this bezel from the remaining clips and set it aside. **Note:** There are eight (8) clips that secure this bezel.



Step 3.

Locate and remove the exposed #T-20 Torx screw from directly to the right of the radio. **Note:** See middle picture for guidance. Please the Custom Bezel Mount over the existing screw hole, replace factory screw, and tighten.

Step 4.

Carefully reinstall the dash in reverse order securing all screws and clips. Install any **Bracketron** phone holder or **Amps** compatible device to your **Custom Bezel Mount**. Your installation is complete.



© Bracketron Inc, 2007 All rights reserved.

The information in this document is subject to change without notice. Bracketron Inc. assumes no responsibility for any errors that may appear in this document nor do we assume any liability in connection with its use. This supersedes and voids all previous literature. Literature already in circulation may not be current. Please contact the sales department for additional information.

Bracketron Inc will not be responsible or liable for damage to vehicles in the installation and or removal of this **Bracketron Inc** mount.

Bracketron Inc will not be liable for personal injuries or damage to property resulting from a motor vehicle accident and or improper installation of this **Bracketron Inc** mount.

Bracketron Inc 9607 Humboldt Ave S, Bloomington, MN 55431, Ph: 952-746-7775 Fax: 1-800-660-1784 Toll Free: 1-866-237-4443

Web Address: www.bracketron.com



Part Number: VOL-101-05

INSTALLATION INSTRUCTIONS

VOLKSWAGEN EOS (2007)



NOTE: READ INSTRUCTIONS COMPLETELY BEFORE INSTALLING THIS BRACKETRON PHONE MOUNT.

All instructions are written from the drivers seat position looking forward at the vehicle dash. We advise caution whenever your removing or handling plastic parts of a vehicles dash. **WARNING:** Unnecessary force or pressure can cause pieces to crack or break.

Logo and part number will be right side up and readable when installed.

TOOLS NEEDED: Dash Trim Tool, (Part #SIT-104), #T-20 Torx driver.

PARTS INCLUDED: One Custom Bezel Mount and Instructions.

LOCATION OF MOUNT: To the Right of the Radio



Step 1.

Begin installation by removing bezel around the radio and climate controls. Using a Dash Trim tool (part #SIT-104) insert it behind the bezel in the location as shown. Work your way around the bezel releasing all the clips. **Note:** Some of the clips are tight so use caution. Set the bezel aside in a safe place.

Step 2.

Continue by removing the four (4) T-20 Torx screws that hold the radio in place. There are two (2) T-20 Torx screws on the left side and two (2) T-20 screws on the right side. Place the screws in a safe place.

Step 3.

Pull the radio out just enough to fit the **Custom Bezel Mount** behind the lower right mounting tab. Push the radio back in place. Replace the four (4) factory T-20 Torx screws and tighten.



Step 4.

Carefully reinstall the dash in reverse order securing all screws and clips. Install any **Bracketron** phone holder or **Amps** compatible device to your **Custom Bezel Mount**.



Your installation is complete

© Bracketron Inc, 2007 All rights reserved.

The information in this document is subject to change without notice. Bracketron Inc. assumes no responsibility for any errors that may appear in this document nor do we assume any liability in connection with its use. This supersedes and voids all previous literature. Literature already in circulation may not be current. Please contact the sales department for additional information.

Bracketron Inc will not be responsible or liable for damage to vehicles in the installation and or removal of this **Bracketron Inc** mount.

Bracketron Inc will not be liable for personal injuries or damage to property resulting from a motor vehicle accident and or improper installation of this **Bracketron Inc** mount.

Bracketron Inc 5249 West 73rd Street, Suite G, Edina, MN 55439, Ph: 952-746-7775 Fax: 1-800-660-1784 Toll Free: 1-866-237-4443

Web Address: www.bracketron.com

INSTALLATION INSTRUCTIONS

VOLKSWAGEN PASSAT (2006-2007)
VOLKSWAGEN PASSAT WAGON (2006-2007)



NOTE: READ INSTRUCTIONS COMPLETELY BEFORE INSTALLING THIS BRACKETRON PHONE MOUNT.

All instructions are written from the drivers seat position looking forward at the vehicle dash. We advise caution whenever your removing or handling plastic parts of a vehicles dash. **WARNING:** Unnecessary force or pressure can cause pieces to crack or break.

Logo and part number will be right side up and readable when installed.

TOOLS NEEDED: Dash Trim Tool, (Part #SIT-104), #T-20 Torx driver.

PARTS INCLUDED: One Custom Bezel Mount and Instructions.

LOCATION OF MOUNT: To the Right of the Radio



Step 1.

Begin installation by removing the bezel around the radio. Using a Dash Trim tool (part #SIT-104) insert it behind the radio in the location as shown. Work your way around the bezel releasing all the clips. **Note:** Some of the clips are tight so use caution. You do not need to disconnect the wiring to the airbag light.

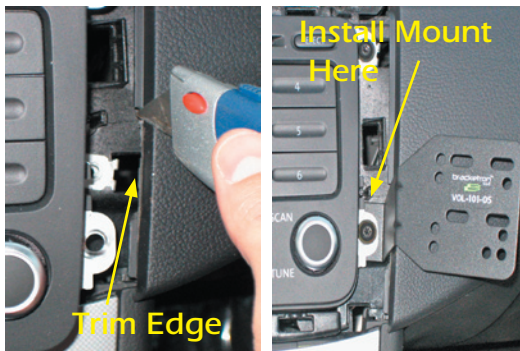

Step 2.

Continue by removing the four (4) T-20 Torx screws that hold the radio in place. There are two (2) T-20 Torx screws on the left side and two (2) T-20 Torx screws on the right side. Place the screws in a safe place.

Step 3.

Pull the radio out just enough to fit the **Custom Bezel Mount** behind the lower right mounting tab. Push the radio back in place. Replace the four (4) factory T-20 Torx screws and tighten.

Step 4.

Carefully reinstall the dash in reverse order securing all screws and clips. Install any **Bracketron** phone holder or **Amps** compatible device to your **Custom Bezel Mount**.

Your installation is complete



© Bracketron Inc, 2007 All rights reserved.

The information in this document is subject to change without notice. Bracketron Inc. assumes no responsibility for any errors that may appear in this document nor do we assume any liability in connection with its use. This supersedes and voids all previous literature. Literature already in circulation may not be current. Please contact the sales department for additional information.

Bracketron Inc will not be responsible or liable for damage to vehicles in the installation and or removal of this **Bracketron Inc** mount.

Bracketron Inc will not be liable for personal injuries or damage to property resulting from a motor vehicle accident and or improper installation of this **Bracketron Inc** mount.

Bracketron Inc 5249 West 73rd Street, Suite G, Edina, MN 55439, Ph: 952-746-7775 Fax: 1-800-660-1784 Toll Free: 1-866-237-4443

Web Address: www.bracketron.com